

## Option Specifications



**Grommet - \$20 each**

Specify G (silver or black)

Round grommet is 2.5” outside diameter. Grommets are drilled by factory in the specified location. Includes two piece insert.



**Table Ganger - \$135 per set**

Specify TG - location

Quick release table gangers are for securing tables together in multiple configurations. Table gangers help prevent accidental electrical disconnection of power supply to adjacent tables. Available on tables with L3 or L19 edges.

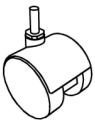

**Casters, Locking- \$20 each**

Liberty, Gateway, Brooklyn and 2” Tower - 2” diameter twin wheel, black. Specify CS1

Pier -1.45”diameter twin wheel, black. Specify CS2

Supreme - 2”diameter twin wheel with neck, black. Specify CS3.

Stealth – 3”diameter twin wheel with neck, silver. Specify CS4



Stealth

**Caster, Locking - \$30 each**

3” Tower – 2.85” diameter twin wheel, black . Specify CS5

**Caster, Locking - \$40 each**

4”Tower – 3.94”diameter twin wheel, black. Specify CS6

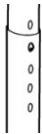

**Adjustable Spring PIN - \$160 list each**

Specify AH

Allows 9” of height adjustment, from 24.75 “ to 33.75” in 1” increments.

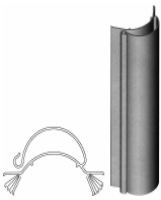

**Wire management**

Vertical – Specify VW (Silver or Black) - **\$25 each** Horizontal – Specify HW - **\$80 list each**

Vertical or Horizontal plastic extrusion routes cables either down table leg or from table to table. Attaches with self adhesive pre-attached tape. Ships loose from factory. Vertical is 22”long and available in black or silver. Horizontal is cut to lengths required for your specific table.

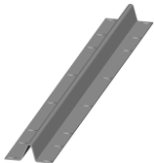

**Anti Sag bar - \$100 list each**

Specify AS

The anti-sag bar is used to prevent table warping.



**Flip Top - \$200 list each**

Specify FT

Flip top is used mostly on round and square tables.

## Option Specifications



### Keyboard Arm and Tray- \$485 list each

Specify K

Keyboard Arm features soft touch knob that adjusts both height and tilt simultaneously, spring assisted to help counterbalance keyboard tray weight. 360 degree swivel allows user to move keyboard freely from side to side, low profile ball bearing track available in (2) lengths 16-3/4" and 31-3/4". Tray is low profile durable plastic, integrated mouse tray which slides for left or right hand use. Overall width dimension of tray is 21", 30" with mouse tray pulled out. Depth of tray is 10-1/2" Arm is epoxy coated steel, tray injection molded plastic, color is black.



### Laptop Drawer - \$480 list each

Specify LD

Laptop drawer allows user to operate laptop while still in drawer. Features include: built in cord management holes, permanent affixed vinyl wrist pad, key locking mechanism that is easy to reach but yet out of sight, tamper proof security screws for attaching to bottom of work surface, and 16 gage metal construction with a durable epoxy finish, black. Anti-theft cables are also available for \$80 list per cable. Model Code: ATC.



### Monitor Arms with thru mount post shown on left.

Made of die cast Aluminum, through mount post construction, silver powder coat finish only. Mounting bracket includes both 3" and 4" spaced holes to comply with the VESA mounting standards and easily rotates from landscape to portrait view, adding pivots for viewing comfort. Vertical travel distance of 9" for correct height, integrated cable management keeps desk clear from unsightly cables. Available in four sizes.



**Short Arm** – Swivel and Tilt only, no spring, extends 3-3/16", supports most 15" and 17" flat screens.

Specify MA1 - **\$310 list each**

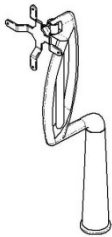

**Medium Arm** – Full movement, extends 13-7/8" at full extension., supports up to 24" flat screens.

Specify MA2 - **\$495 list each**

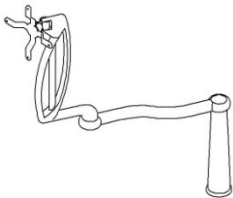

**Long Arm** – Full movement, extends 20-3/4" at full extension., supports up to 24" flat screens.

Specify MA3 - **\$565 list each**



**Dual Arm** – Includes long arms (only) full movement, each arm extends 20-3/4" at full extension., supports up to 24" flat screens.

Specify MA4 - **\$1110 list each**

## Option Specifications



### Laminate Modesty Panel

Specify ML – 36", 210 list  
 Specify ML – 48", 230 list  
 Specify ML – 60", 270 list  
 Specify ML – 72", 285 list

Laminated modesty panel is .75" thick with black or silver PVC edges.

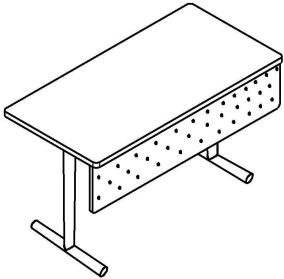

### Metal Modesty Panel

Specify MM – 36", 210 list  
 Specify MM – 48", 230 list  
 Specify MM – 60", 270 list  
 Specify MM – 72", 285 list

Metal modesty panel is steel with perforated holes in either black or silver.



### Fixed CPU Holder - \$110 each

Specify C2-standard unit, C1-smaller unit

The fixed CPU holder securely clamps and holds cpu. Height adjustment of 13-3/8"- 20-1/2", Choice of two width adjustments, standard 5-1/2"-9-1/4" or 2-3/4"-5-1/4" to accommodate new smaller cpu units. Black powder coat finish.



### Swivel CPU Holder - \$180 each

Specify C4-standard unit, C3-smaller unit

The 360 degree swivel CPU holder includes 8-1/2" of travel extension and securely clamps and holds cpu. Height adjustment of 14-5/8"-20-1/2", Choice of two width adjustments, standard 5-1/2"-9-1/4" or 2-3/4"-5-1/4" to accommodate new smaller cpu units. Black powder coat finish